



Looking up-river to site of proposed Arboretum Bridge

- High Tide - cormorants sit atop fallen tree lodged on river bottom at confluence of Watts Branch and the Anacostia

Port Town Community Boathouse Youth recreational programs



Middle school team at Kenilworth Park

*Anacostia
Swim Team
gets a
new member*



*Catching
a crab in the
Upper
Anacostia*



*special events and
adult recreational programs*

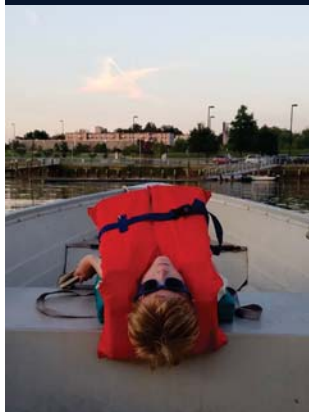



Mayor's Boat Bladensburg Races 2014

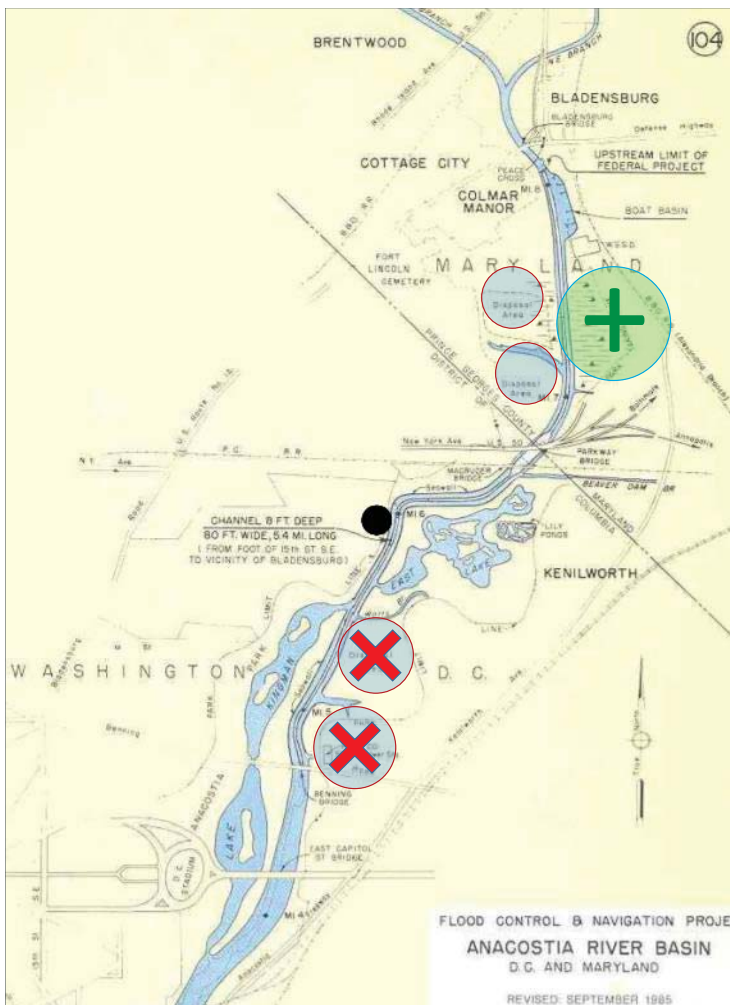

Major developments after 1985

- Establishment of Kenilworth Park/
dump capped
- Demolition of PEPSCO Power Plant
- Creation of ANA 11 wetlands
- Construction of ARWT

Channel no longer
8 ft deep by 80 ft wide

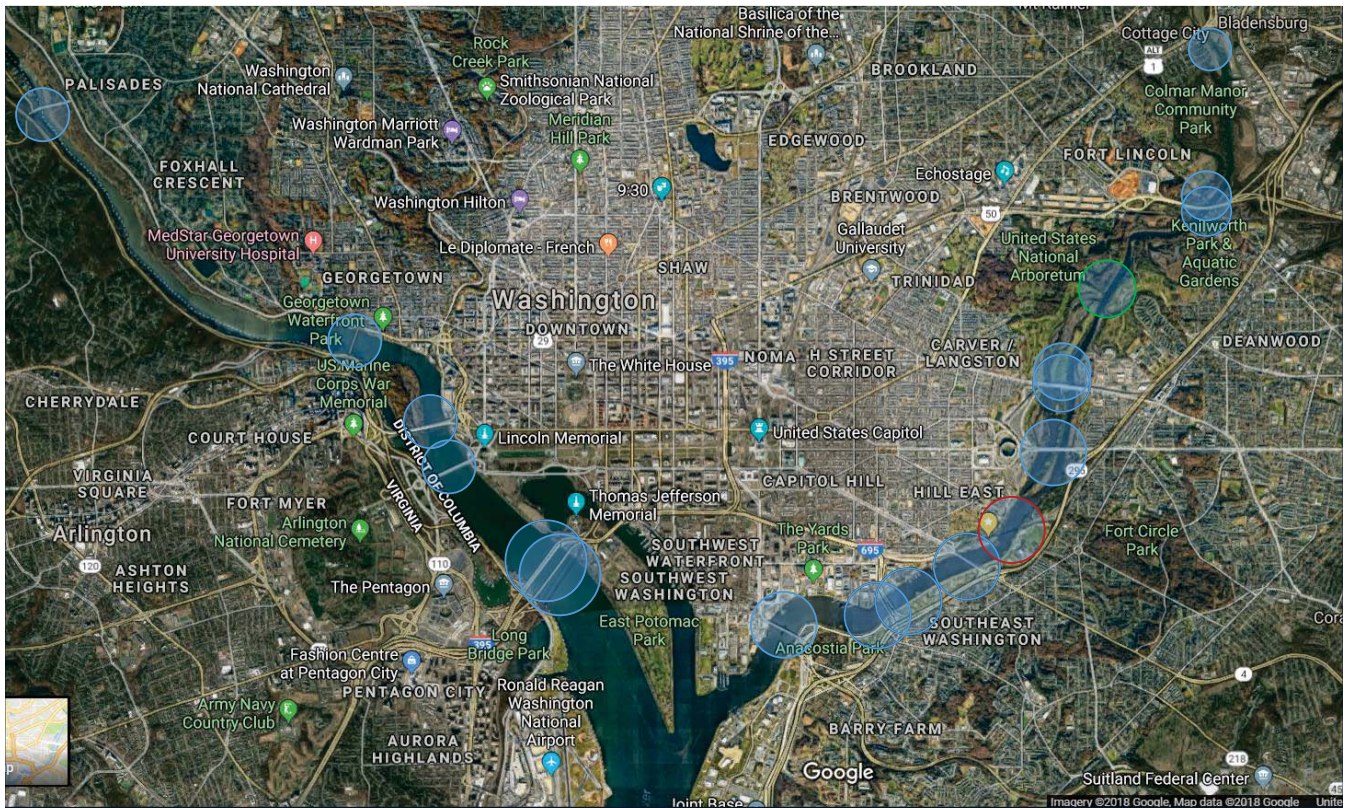

- 11 existing bridges in 1st 7 miles of the Anacostia
- 5 in Upper Anacostia

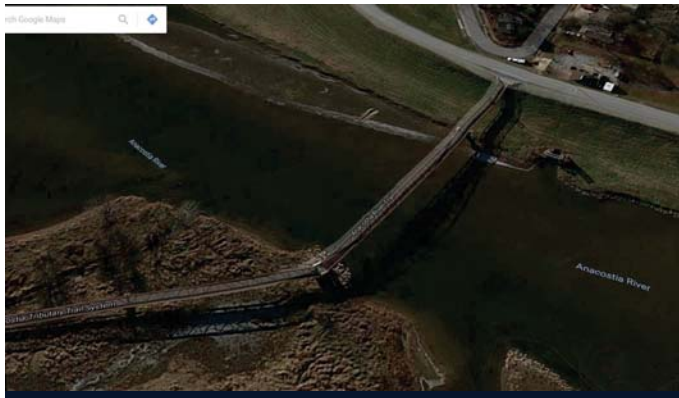

Anacostia Tributary Trail Pedestrian Bridge

- clear span from Bladensburg Marina to Colmar Manor





Pier at ANA 11

- reduced width of channel by $\frac{1}{4}$ at high tide – $\frac{1}{3}$ at low tide
- unusable by rowing shells (most common craft on upper Anacostia)
- no boat parking, no way to get boat across wetlands
- Extremely limited use



Construction of ARWT at New York Ave Bridge:
Barge and skiff at berthing pier



Boat traffic pattern at New York Ave and AMTRAK Bridges
 -two 80 ft spans rendered unusable by construction of ARWT

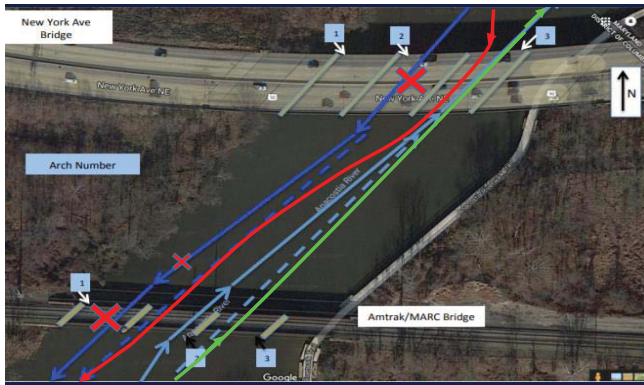

Boat traffic pattern at New York Ave Bridge
 - boats maneuver to enter correct span by crossing river between bridges





Lower Beaverdam Creek

left: before
completion of
ARWT at Route
50 Bridge
below: after



AMTRAK Bridge

Condensation forms on underside of bridge causing slip hazard – wet or icy concrete surface at sharp turn



Kenilworth Aquatic Gardens – tidal gut before ARWT





Narrow turn after tidal gut



Existing Dock at National Arboretum

- Sediment build up/no shell landing



Hickey Run –
Golf Course
Bridge



2014

*Watts Branch
sandbars*



2017



Sandbars at Watts Branch and Hickey Run

- narrow and sinuous navigable channel for traffic in both directions

RECOMMENDED PEDESTRIAN BRIDGE - PLAN AND ELEVATION

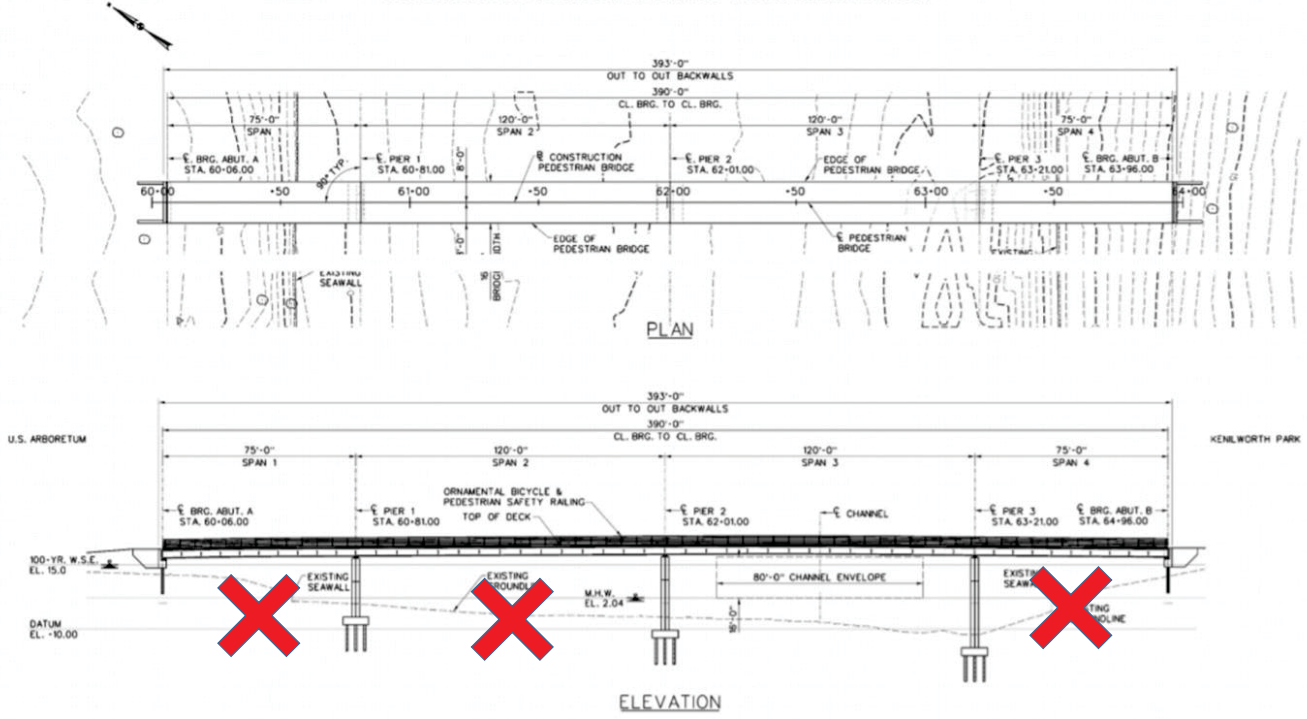

3 span bridge creates one maneuverable span

- narrow and sinuous navigable channel

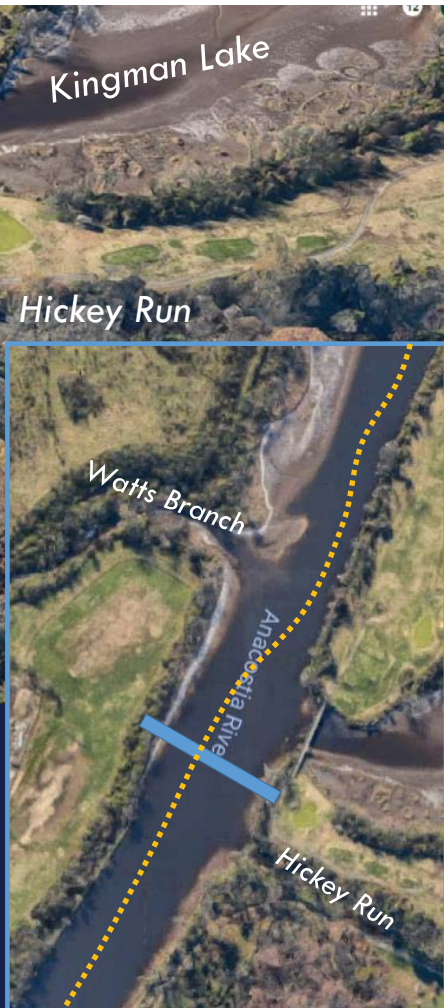

Boat traffic pattern at Watts Beach, Hickey Run and Langston Bridge



Extensive sandbar at Watts Branch east of Kingman and Heritage Islands



Positive development along Kingman/Heritage Corridor:

- Decommissioning and demolition of PEPCO PLANT
- Closing and capping of Kenilworth Dump
- Designation of Nature Preserve by Mayor Bowser



Watts Branch sandbar extends into PEPCO Lagoon



Single usable span at Benning obstructed by sandbar and bollard

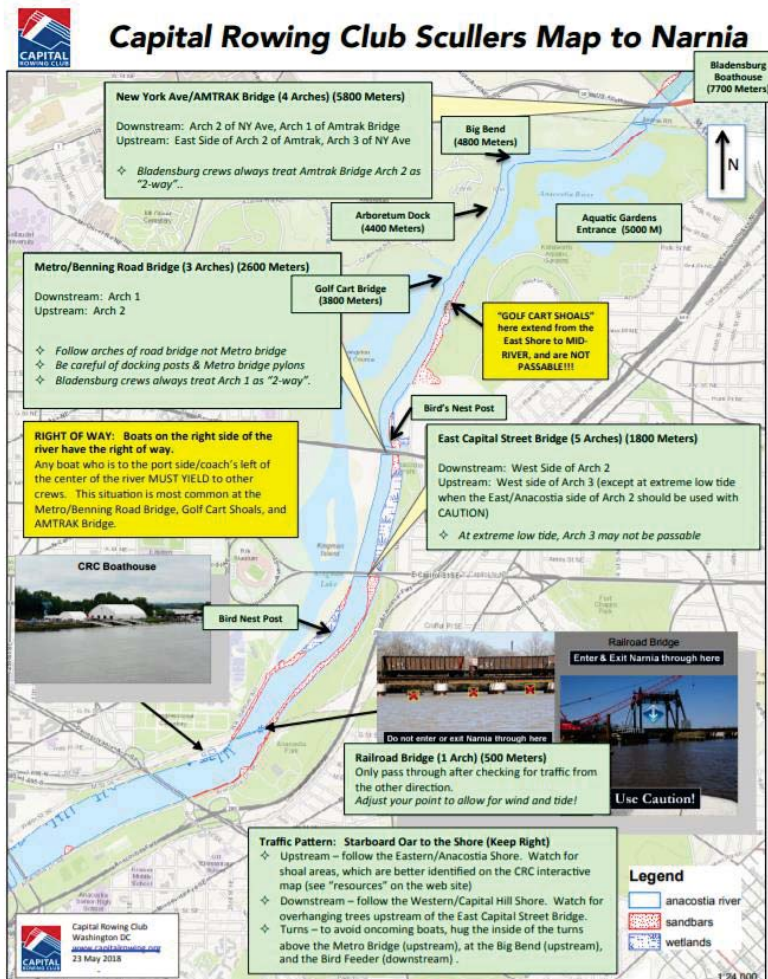

Anacostia Community Boathouse Navigation Map

(directions necessary for safe navigation of Upper Anacostia - complexity demonstrates number of existing hazards created largely by human intervention)

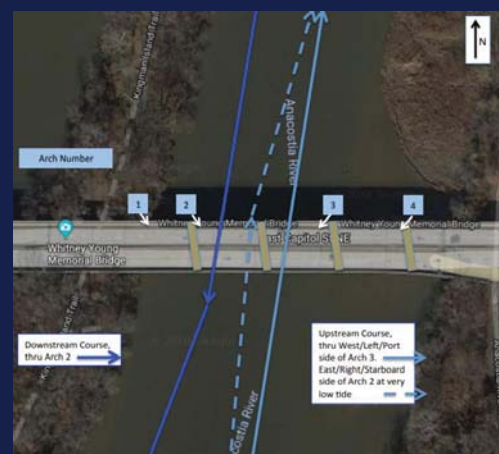
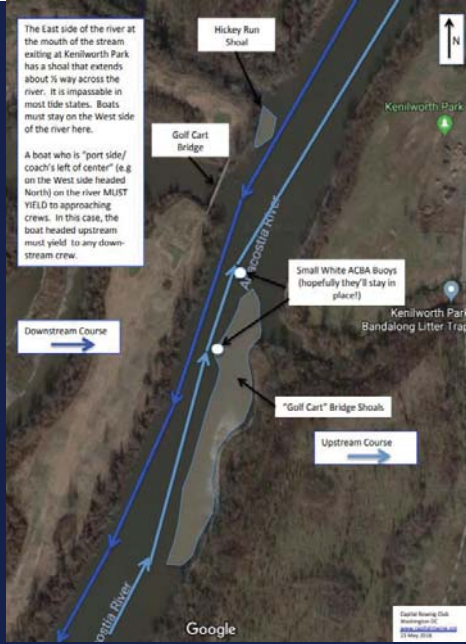

FREDERICK DOUGLASS
MEMORIAL BRIDGE PROJECT

d. DISTRICT OF COLUMBIA
GOVERNMENT OF THE DISTRICT OF COLUMBIA
MURIEL BOWSER, MAYOR

NEW THE FREDERICK DOUGLASS MEMORIAL BRIDGE

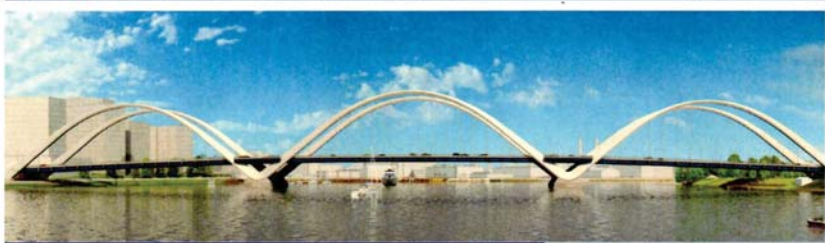

FACT SHEET

2018
2021

ABOUT THE PROJECT

The Frederick Douglass Memorial Bridge Project calls for replacing the 68-year-old bridge and reconstruction of the Suitland Parkway/I-295 interchange. The bridge has been classified functionally obsolete and needs to be replaced due to its condition, age and functional limitations. This project will increase pedestrian and vehicular safety, improve multimodal transportation options, increase community accessibility and support economic development on both sides of the Anacostia River.

This project is one in a series of transportation, environmental, economic, community, and recreation projects developed by the larger Anacostia Waterfront Initiative (AWI) Program. From the Tidal Basin to the city's northeast border with Maryland, the 30-year, \$10 billion AWI Program is transforming the shores of the Anacostia River into a world-class waterfront and enriching nearby communities. For more information about AWI, visit the website: anacostiawaterfront.org.

KEY PROJECT ELEMENTS

- Building a new six-lane Frederick Douglass Memorial Bridge
- Creating a new traffic oval west of the river that connects South Capitol Street, Potomac Avenue and Q Street SW
- Creating a new at-grade traffic oval east of the river that connects South Capitol Street, Suitland Parkway and Howard Road SE
- Reconstructing the Suitland Parkway/Interstate 295 interchange
- Constructing a new diamond interchange on Suitland Parkway at Martin Luther King Jr. Avenue
- Increasing bicycle and pedestrian facilities
- Improving drainage and storm water management throughout the corridor

PROJECT START: SUMMER 2017 | PROJECT COMPLETION: END OF 2021

PROJECT CONTACT: info@newfrederickdouglassbridge.com
STAY CONNECTED BY VISITING: www.newfrederickdouglassbridge.com

NEW THE FREDERICK DOUGLASS MEMORIAL BRIDGE

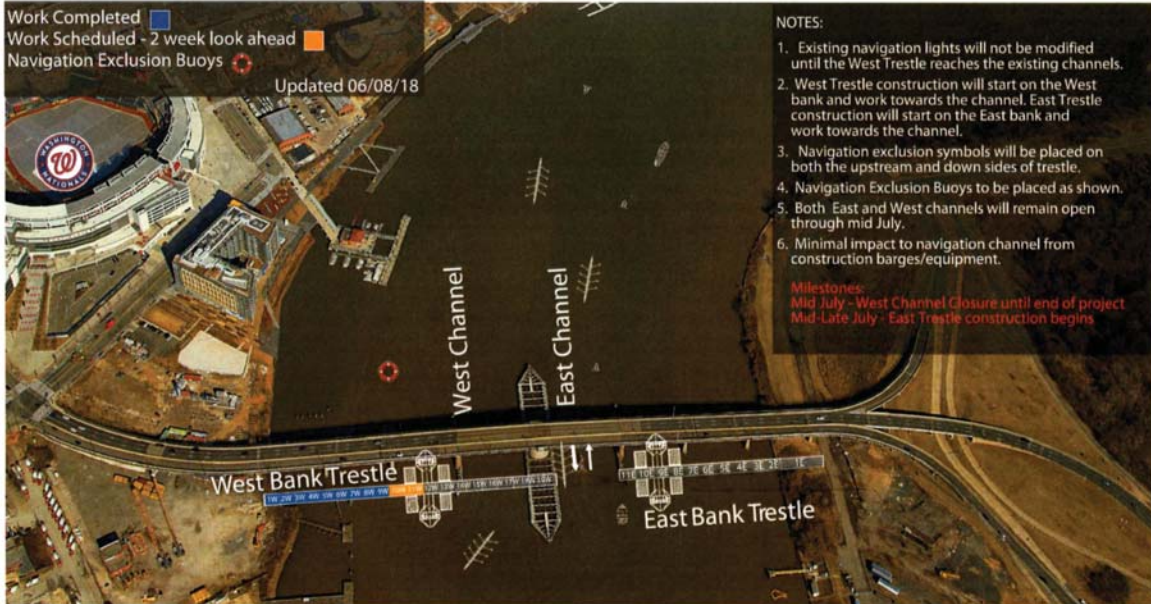

1220 12TH STREET, SE
WASHINGTON, D.C. 20003

202.299.2189
info@newfrederickdouglassbridge.com
www.newfrederickdouglassbridge.com



We value our River and
want to protect and enjoy it.